

FARRIS, HANSEN & ASSOCIATES, INC.

ENGINEERING — ARCHITECTURE — SURVEYING
7 RIDGWAY COURT — P.O. BOX 437 — ELKHORN, WISCONSIN 53121
PHONE: (262) 723-2098 FAX: (262) 723-5886

PLAT OF SURVEY

PART OF THE NW 1/4 SECTION 1
TOWN 1 NORTH, RANGE 17 EAST
CITY OF LAKE GENEVA
WALWORTH COUNTY, WISCONSIN

— PIER WORK ORDERED BY —
REED CONSTRUCTION
W3199 SOUTH LAKESHORE DRIVE
LAKE GENEVA, WI. 53147

— WORK ORDERED BY —
FAIRWYN
875 TOWNLINE ROAD, SUITE 102
LAKE GENEVA, WI. 53147



- LEGEND
- = FOUND IRON PIPE STAKE
 - = FOUND IRON REBAR STAKE
 - (XXX) = RECORDED AS

ASSIGNED THE NORTH LINE OF LOT 3
N 88D30'27" W

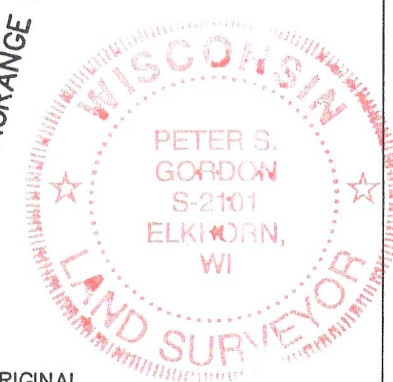
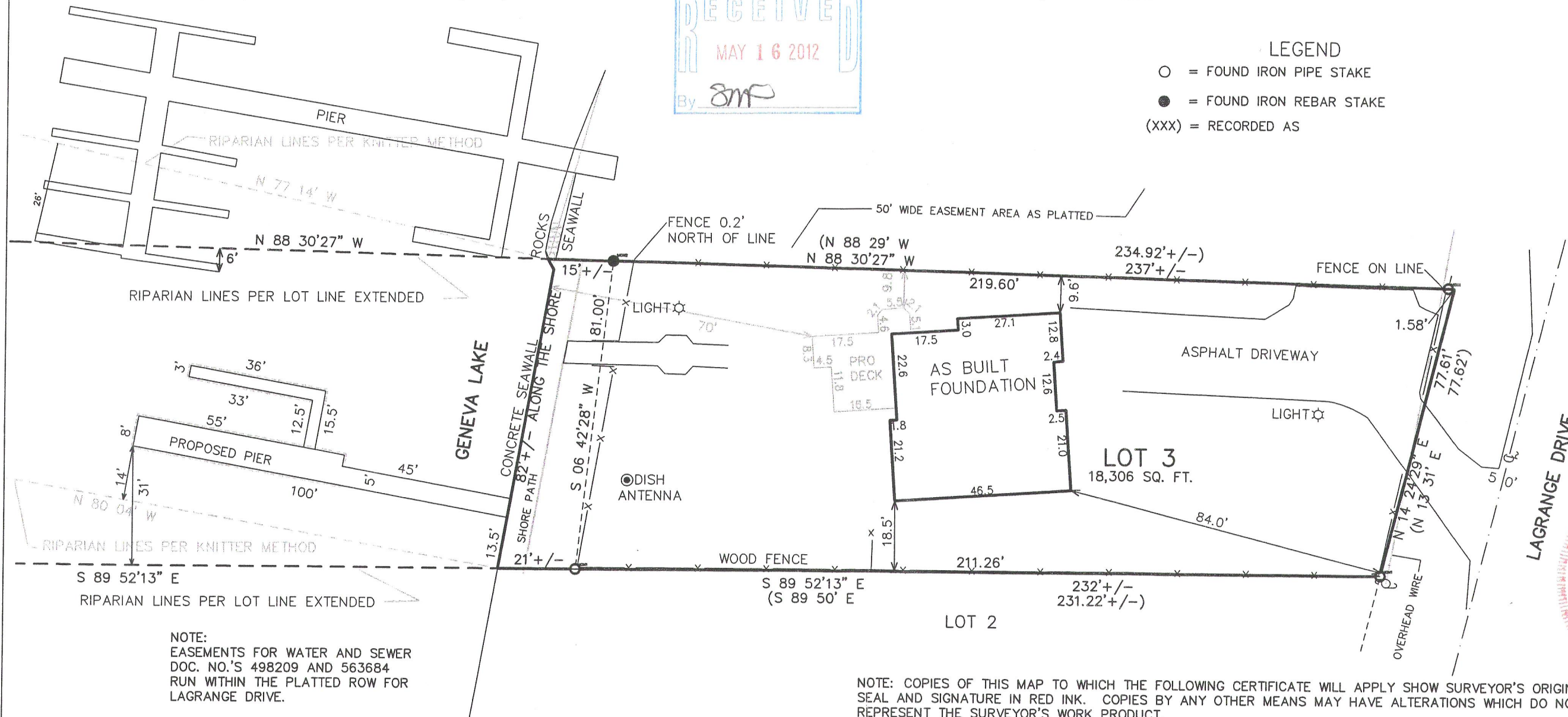

NOTE: COPIES OF THIS MAP TO WHICH THE FOLLOWING CERTIFICATE WILL APPLY SHOW SURVEYOR'S ORIGINAL SEAL AND SIGNATURE IN RED INK. COPIES BY ANY OTHER MEANS MAY HAVE ALTERATIONS WHICH DO NOT REPRESENT THE SURVEYOR'S WORK PRODUCT.

I HEREBY CERTIFY THAT THE ABOVE DESCRIBED PROPERTY HAS BEEN SURVEYED UNDER MY DIRECTION AND THAT THE ABOVE MAP IS A TRUE REPRESENTATION THEREOF AND SHOWS THE SIZE AND LOCATION OF THE PROPERTY, ITS EXTERIOR BOUNDARIES, THE LOCATION OF ALL VISIBLE STRUCTURES, AND DIMENSIONS OF ALL PRINCIPLE BUILDINGS THEREON, BOUNDARY FENCES, APPARENT EASEMENTS, ROADWAYS, AND VISIBLE ENCROACHMENTS, IF ANY. THIS SURVEY IS MADE FOR THE USE OF THE PRESENT OWNERS OF THE PROPERTY, AND ALSO THOSE WHO PURCHASE, MORTGAGE, OR GUARANTEE THE TITLE THERETO WITHIN ONE YEAR FROM THE DATE HEREOF.

DATED: OCTOBER 13, 2010

Peter S. Gordon
PETER S. GORDON R.L.S. 2101

REVISED 10-28-2011
TO SHOW PROPOSED RESIDENCE
AND DECK

REVISED 12-22-2011
TO SHOW SIZE & LOCATION OF
FOUNDATION AS BUILT

REVISED 03-13-2012
TO SHOW PROPOSED PIER &
RIPARIAN LINES

PROJECT: 8253
DATE: 11-13-2010
SHEET 1 OF 1

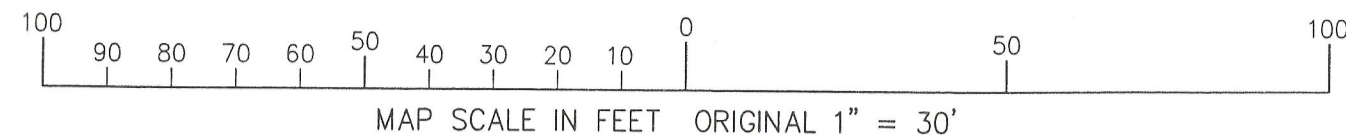

ZLE-3

007-2855

MAR 13 2012

3/13/2012